

Setting Up Your Comwave Mobile App



Customers now have the option to download the Comwave long distance mobile app free with their LD account. The app allows users to dial long distance calls directly from their cell phone and enjoy great long distance rates which are billed to their Comwave account.



Step 1

Search "Comwave Mobile" in your app store and click on the Comwave Mobile app.

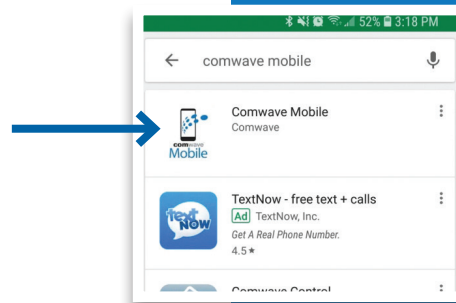

Step 2

Click **Install**. Once the installation is complete, open the app and click on "Activate App".

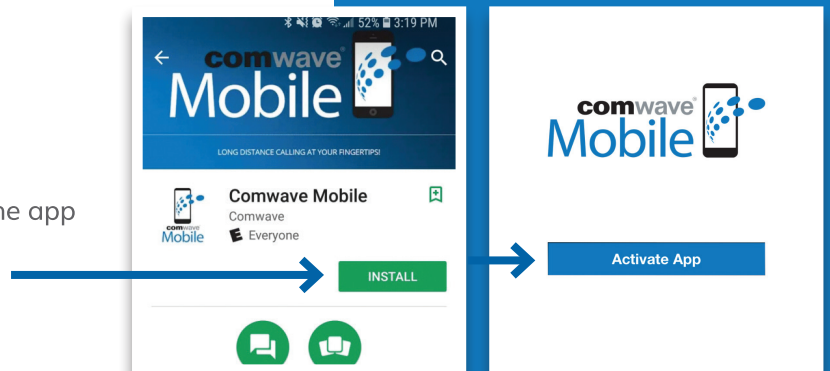

Step 3

Enter your Mobile Phone Number along with your Comwave PIN.

Note: Your Comwave PIN can be found under "My Account". Select 'PIN' and then select the mobile number you are using for the app and your 5 digit PIN will be displayed.

Click **Save** and enjoy using the Comwave Mobile App.

